



constructive solutions

SILANE & SILANE-SILOXANE SURFACE TREATMENTS

NITOCOTE SN RANGE

Enhance service life

Fosroc's range of high performance penetrating silane and silane-siloxane surface treatments are designed to maintain the appearance of concrete while protecting it from environmental effects.

Silane and silane-siloxane based sealers penetrate into porous concrete and masonry substrates then react, to produce a bonded hydrophobic lining in the pores. They protect concrete surfaces from the intrusion of water and chloride ions to enhance the service life, allowing the passage of water vapour out of the substrate without changing the surface appearance.*



NITOCOTE SN502

Single-component, silane-siloxane based treatment that sits at the surface of the concrete to reduce the absorption of water and water borne salts.

Typical applications – atmospherically exposed concrete structures in coastal environments.

Advantages

- ✓ Silane-siloxane blend
- ✓ Larger molecules for shallower penetration – sits at the surface
- ✓ Produces a water beading effect

*Nitocote SN502 does not discolour the substrate, however Nitocote SN502 may darken some polymer modified substrates and white cement. A trial area is recommended.



NITOCOTE SN508 CRÈME

(Previously known as Emer-Stop Crème)

Thixotropic, water dispersed emulsion of iso-octyltriethoxysilane that penetrates the surface of concrete over a few hours.

Typical applications – atmospherically exposed concrete surfaces of bridges, wharves, roads, buildings and other structures.

Advantages

- ✓ Contains >80% silane
- ✓ Water based
- ✓ Less volatile than Nitocote SN511
- ✓ Cream consistency prevents drips and runs
- ✓ Good for windy conditions and elevated temperatures
- ✓ Produces a water beading effect



NITOCOTE SN511

(Previously known as Emer-Stop S100N)

Low viscosity, solvent free, isobutyltriethoxysilane that penetrates deeply into porous substrates to reduce absorption of water and water borne salts.

Typical applications – atmospherically exposed concrete structures in marine and coastal environments.

Advantages

- ✓ Contains >98% silane
- ✓ Deeply penetrating
- ✓ Good for dense concrete
- ✓ Produces a water beading effect

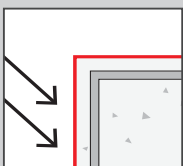

Protective Coatings

For further information on our protective coatings range visit fosroc.com.au or fosroc.co.nz
Always refer to the product TDS before making your final selection or speak to your Fosroc representative.

NITOCOTE SN RANGE

Product Selector

This selector is a general guide only, please contact your Fosroc Representative for more information.

Suitable for:	Silane		Silane-siloxane blend
	Nitocote SN511	Nitocote SN508 Crème	Nitocote SN502
Concrete – old	■		■
Concrete – new	■	■	
Concrete – blocks			■
Mortar / grout			■
Pavers			■
Sandstone			■
Unsealed roof tiles			■
Unsealed floor tiles – terracotta			■
Wall bricks			■

Properties

NITOCOTE SN502

Active ingredient	Silane-siloxane blend
VOC content:	697 g/l
Number of coats	2 flood coats
Overcoating time	2 hours @ 20°C
Application rate	0.2 l/m ² per coat

NITOCOTE SN511

Active ingredient	>80% silane
VOC content:	880 g/l
Number of coats	Minimum 2 flood coats
Overcoating time	6 hours @ 20°C
Application rate	0.3 l/m ² per coat

NITOCOTE SN508 CREME

Active ingredient	>98% silane
VOC content:	9 g/l
Number of coats	1-2 flood coats
Overcoating time	N/A
Application rate	0.25 - 0.44 l/m ² per coat

Supply

Description	Coverage	Size	Product Code
Nitocote SN502	5 m ² /l	20L	FC855145-20L
Nitocote SN508 Creme	2.25 - 4 m ² /l	30L	FC855150-30L
		200L	FC855150-200L
Nitocote SN511	3.33 m ² /l	20L	FC855155-20L
		200L	FC855155-200L

Please refer to the Technical Data Sheet for further information about this product.

AU 1800 812 864
fosroc.com.au

NZ 0800 657 156
fosroc.co.nz

Parchem Construction Supplies Pty Ltd
1956 Dandenong Rd, Clayton VIC AUS 3168

Distributed in New Zealand by Concrete Plus Ltd
150 Hutt Park Road, Gracefield NZ 5010

Fosroc and the Fosroc logo are trade marks of Fosroc International Limited, used under licence.